

COVID-19 Antibody Detection Operation Instructions

1. Preparation

Open the box and take out the built-in items. Tear the packaging bag and take out the test card. Place the test card flat on the table at room temperature.



2. Disinfection

Wipe and disinfect fingertip part for the blood collection with alcohol cotton patch and let it dry naturally.



3. Blood Collection

Massage fingers to increase blood circulation. Uncover the protective cap of the blood taking needle and place the needle side on the blood collection site. Quickly pierce your finger by the needle and press to the end, then immediately take it out. If the blood does not come out sufficiently, squeeze the finger from the distal end of the blood collection site to the fingertip to obtain more blood.

Note: two blood taking needles are in the package and one is spare.

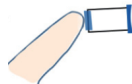
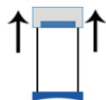

4. Dilution



Don't drop the undiluted blood directly into the sample loading hole of the test card!

Pipette two drops (soybean size) of the blood into the diluent preservation tube, and gently blow 5 times by the pipette. Press the wound with sterile cotton swab for a while to stop bleeding.



5. Sample Loading

Take 80 μL of diluted blood samples (according to the pipette scale) and put into the sample hole of IgM and IgG antibody test card respectively.



6. Test

Leave the test card at room temperature for 10-15 minutes and observe the results.

10-15 mins

Note: the result obtained beyond 15 minutes is invalid!



7. Result Interpretation

IgM and IgG test card

- 1) IgM+ IgG+: double positive. Please go to the designated hospital for nucleic acid test immediately.
- 2) IgM+ IgG-: single IgM positive. Please go to the designated hospital for nucleic acid test immediately.
- 3) IgM- IgG+: single IgG positive. Please go to the designated hospital for nucleic acid test immediately.
- 4) IgM- IgG-: double negative. Congratulations, you are temporarily safe. Please continue to take strict precautions.

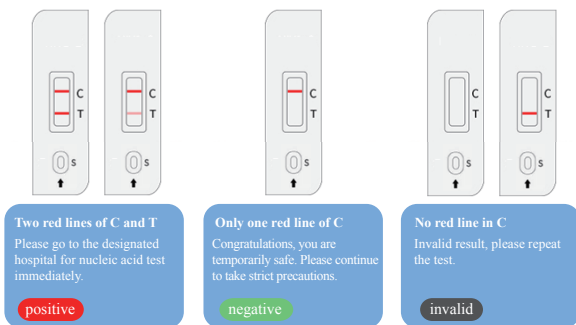

8. Waste Disposal

After the test is done, put the blood taking needle, test card and other wastes into the sealed package, disinfect with 84 disinfectant or 75% alcohol, and discard them.